

# Strada Street Light

## 100W

### Applications:

Residential and Commercial Applications.

- Highly Durable LED Street Light constructed with a Die-Cast aluminium housing & PC Lens.
- Philips 3030 LED delivering an effective 150lm/W with a rated lifespan of L80B10 @ 50 000hrs.
- Type II-S beam angle preventing unnecessary backward light pollution.
- Wide input Voltage range 100V-277V with a 10kV (replaceable) built in surge protection allowing for maximum durability and robustness over the LED Luminaires lifespan.
- Wide operating temperature range of -25°~50°.
- Fits a standard D40-60mm Pole or D76-84 with our optional Pole Mount Adaptor HS016.
- IP66 rated luminaire with a CRI>83 for improved clarity & colour rendering.
- Nema Sensor ready LED Street light (60W/100W) for hassle free installation.
- Tool free maintenance with the Strada's gasket sealed power supply housing.

### Product Performance

|  |   |
|--|---|
| <b>Wattage</b>                             | 100W  |
| <b>Colour Temperature &amp; Stock Code</b> | • 5700K - <b>HS004</b> / 4000K - <b>HS005</b> |
| <b>Operating Temperature</b>               | -25~50°C                                      |
| <b>Life Span/ LB Rating</b>                | L80B10@50000hr                                |
| <b>IP Rating</b>                           | IP66  |
| <b>LED Driver Brand</b>                    | High Spec PioLED Driver                       |
| <b>Beam Angle</b>                          | T2-S  |
| <b>Impact Protection Grade</b>             | IK08  |
| <b>Input Voltage</b>                       | 100-277V                                      |
| <b>Surge Protection</b>                    | 10kV (Replaceable)                            |
| <b>Power Factor</b>                        | 0.95  |
| <b>CRI</b>                                 | >83   |
| <b>Lumen Output</b>                        | 15 000 Lumens <i>from Batch 2406 17 000</i>   |
| <b>Lumen Efficiency</b>                    | 150lm/W <i>from Batch 2406 170 lm/W</i>       |
| <b>LED Chips</b>                           | Philips 3030                                  |
| <b>LED Chips Qty</b>                       | 128   |
| <b>Dimmable</b>                            | Non-Dimmable                                  |
| <b>Dimmable Range</b>                      | -   |
| <b>(Dali/Trailing/Leading)</b>             | -   |
| <b>UGR</b>                                 | -   |

### Physical Characteristics

|                                |   |
|--------------------------------|---|
| <b>Weight (g)</b>              | 4200  |
| <b>Housing Material</b>        | Pure Aluminium + PC Len   |
| <b>Product Dimensions (mm)</b> | 245*550*172   |
| <b>Cable Length</b>            | -   |
| <b>Mounting Option</b>         | Fits a standard D40-60mm Pole or D76-84 with our optional Adaptor HS016 |
| <b>Bracket Material</b>        | -   |
| <b>Bolts and Screws</b>        | 316 Stainless steel   |

## Luminous Intensity Distribution Diagram

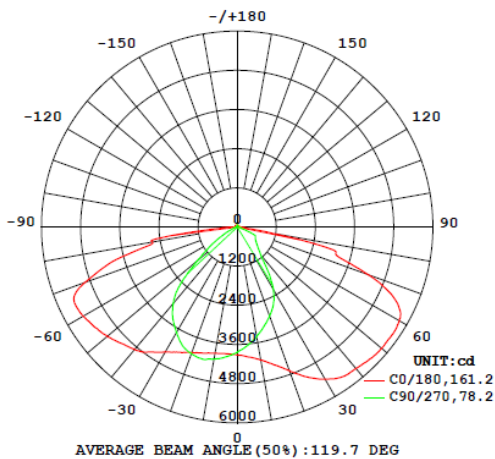

## Packaging



## Dimension Drawing

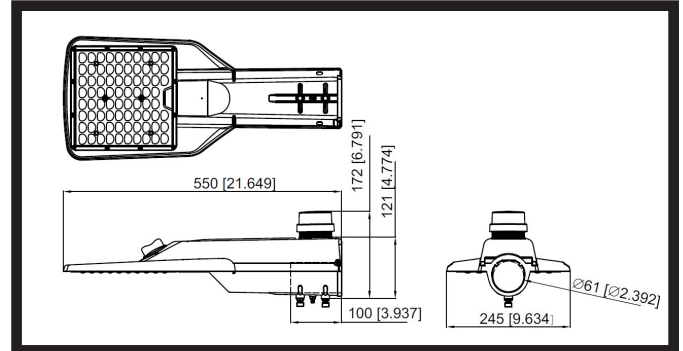

## Technical Parameters

|                           |                                      |
|---------------------------|--------------------------------------|
| Input Current             | 1.1A                                 |
| Output Voltage            | 46.4V                                |
| Humidity                  | 10-98%                               |
| Frequency                 | 50/60Hz                              |
| In Rush Current           | 70A                                  |
| Output Current            | 2380mA                               |
| THD                       | ≤20%                                 |
| TA & TC                   | TA=60/TC=90                          |
| IES (Yes or No)           | Yes                                  |
| Regulatory Qualifications |                                      |
| Class Rating              | Class II                             |
| Energy Efficiency         | 88%                                  |
| Certification             | CE, EMC, IEC60598, ErP               |
| Accessories               |                                      |
| Optional accessories      | 76-84mm Strada Adaptor- <b>HS016</b> |
| Packaging info            |                                      |
| Storage Temp              | -20~+50°                             |
| Carton Size (mm)          | 610*285*200                          |
| QTY/CTN                   | 1                                    |
| Net Weight                | 4.2                                  |
| Gross Weight              | 5.1                                  |

# Strada Accessories

## HS016 - Aluminium Adaptor for Strada 76-84mm

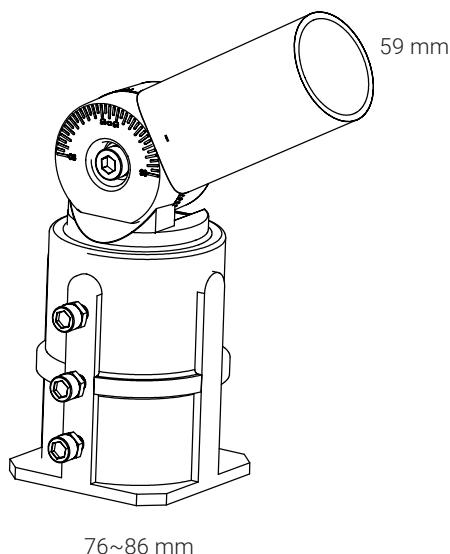
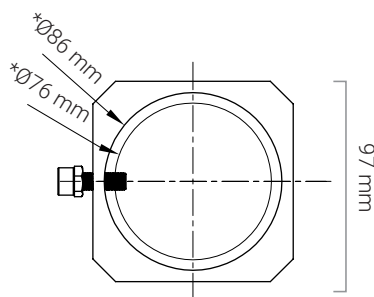

| Physical Characteristics |                    |
|--------------------------|--------------------|
| <b>Weight (kg)</b>       | 1,08               |
| <b>Housing Material</b>  | Die Cast Aluminium |
| Packaging info           |                    |
| <b>Carton Size (mm)</b>  | 505*330*415        |
| <b>QTY/CTN</b>           | 20                 |
| <b>Net Weight</b>        | 19.2               |
| <b>Gross Weight</b>      | 20                 |

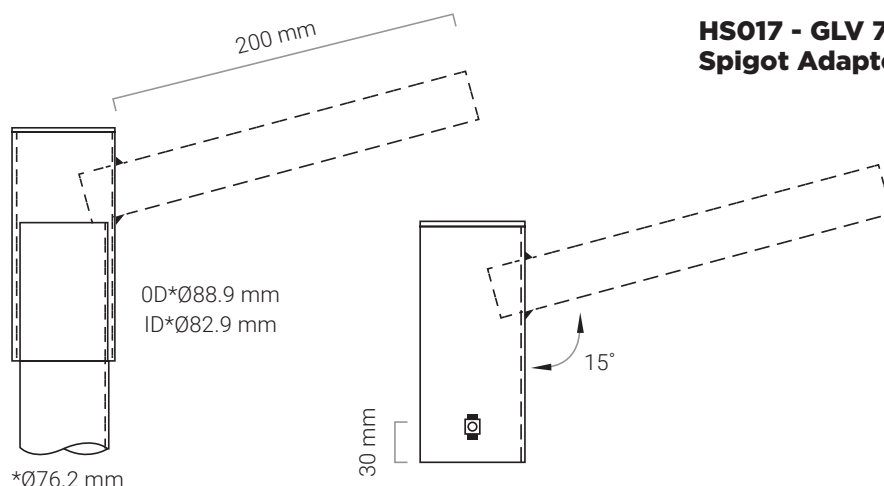
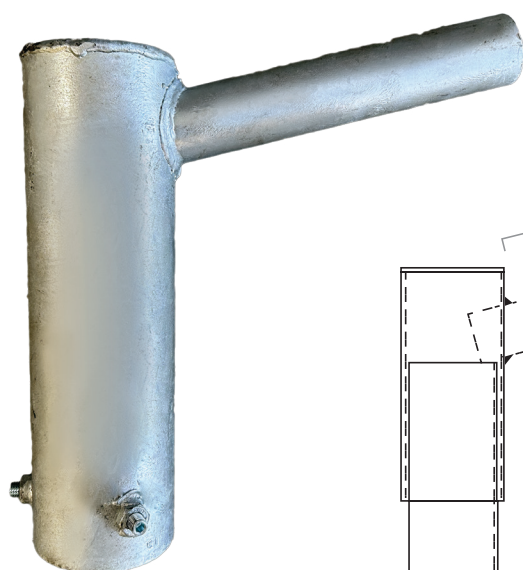

## HS017 - GLV 76mm Spigot Adaptor