

Strada Street Light

60W

Applications:

Residential and Commercial Applications.

- Highly Durable LED Street Light constructed with a Die-Cast aluminium housing & PC Lens.
- Philips 3030 LED delivering an effective 150lm/W with a rated lifespan of L80B10 @ 50 000hrs.
- Type II-S beam angle preventing unnecessary backward light pollution.
- Wide input Voltage range 100V-277V with a 10kV (replaceable) built in surge protection allowing for maximum durability and robustness over the LED Luminaires lifespan.
- Wide operating temperature range of -25°~50°.
- Fits a standard D40-60mm Pole or D76-84 with our optional Pole Mount Adaptor HS016.
- IP66 rated luminaire with a CRI>83 for improved clarity & colour rendering.
- Nema Sensor ready LED Street light (60W/100W) for hassle free installation.
- Tool free maintenance with the Strada's gasket sealed power supply housing.

Product Performance

Wattage	60W
Colour Temperature & Stock Code	• 5700K - HS001 / 4000K - HS002
Operating Temperature	-25~50°C
Life Span/ LB Rating	L80B10@50000hr
IP Rating	IP66
LED Driver Brand	High Spec PioLED Driver
Beam Angle	T2-S
Impact Protection Grade	IK08
Input Voltage	100-277V
Surge Protection	10kV (Replaceable)
Power Factor	0.95
CRI	>83
Lumen Output	9000 Lumens <i>from Batch 2406 10 200</i>
Lumen Efficiency	150lm/W <i>from Batch 2406 170 lm/W</i>
LED Chips	Philips 3030
LED Chips Qty	80
Dimmable	Non-Dimmable
Dimmable Range	-
(Dali/Trailing/Leading)	-
UGR	-

Physical Characteristics

Weight (g)	2900
Housing Material	Pure Aluminium + PC Len
Product Dimensions (mm)	195*440*165
Cable Length	-
Mounting Option	Fits a standard D40-60mm Pole or D76-84 with our optional Adaptor HS016
Bracket Material	-
Bolts and Screws	316 Stainless steel

Luminous Intensity Distribution Diagram

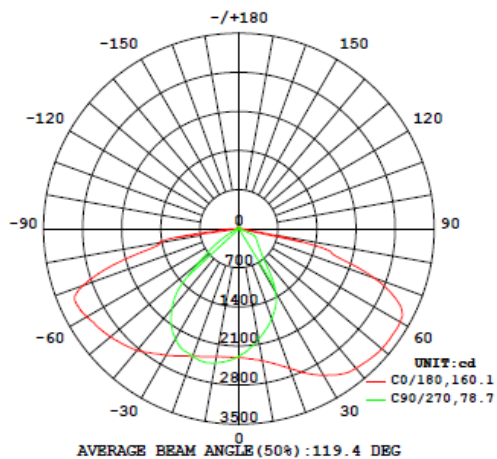

Packaging



60W LED Strada Street Light

- High Lumen 3030 LED
- Contemporary Matt Black Finish
- Die Cast Aluminum Housing
- 10kV Surge Protection
- 9000LM- Type II-S
- L80B10 @ 50000hrs
- 5 Year Warranty



High Lumen
150LMW
60W
IP66
5 Year Warranty

Dimension Drawing

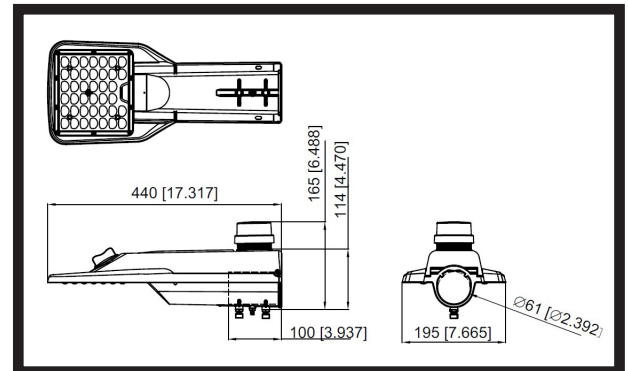

Technical Parameters

Input Current	0.67A
Output Voltage	46.4V
Humidity	10-98%
Frequency	50/60Hz
In Rush Current	45A
Output Current	1160mA
THD	≤20%
TA & TC	TA=60/TC=90
IES (Yes or No)	Yes

Regulatory Qualifications

Class Rating	Class II
Energy Efficiency	88%
Certification	CE, EMC, IEC60598, ErP

Accessories

Optional accessories	76-84mm Strada Adaptor- HS016 GLV 76mm Spigot- HS017
----------------------	---

Packaging info

Storage Temp	-20~+50°
Carton Size (mm)	500*235*190
QTY/CTN	1
Net Weight	2.9
Gross Weight	3.4

Strada Accessories

HS016 - Aluminium Adaptor for Strada 76-84mm

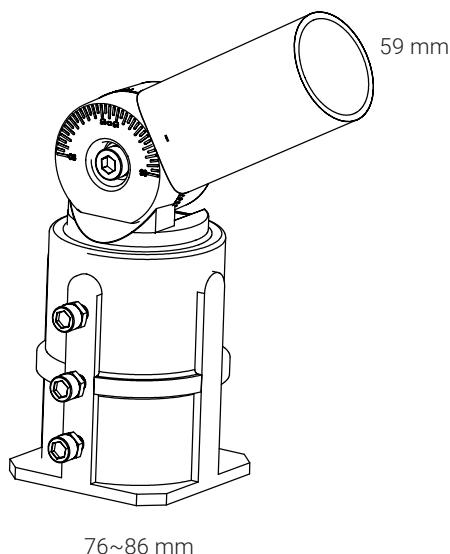
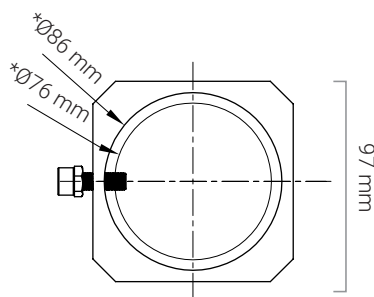

Physical Characteristics	
Weight (kg)	1,08
Housing Material	Die Cast Aluminium
Packaging info	
Carton Size (mm)	505*330*415
QTY/CTN	20
Net Weight	19.2
Gross Weight	20

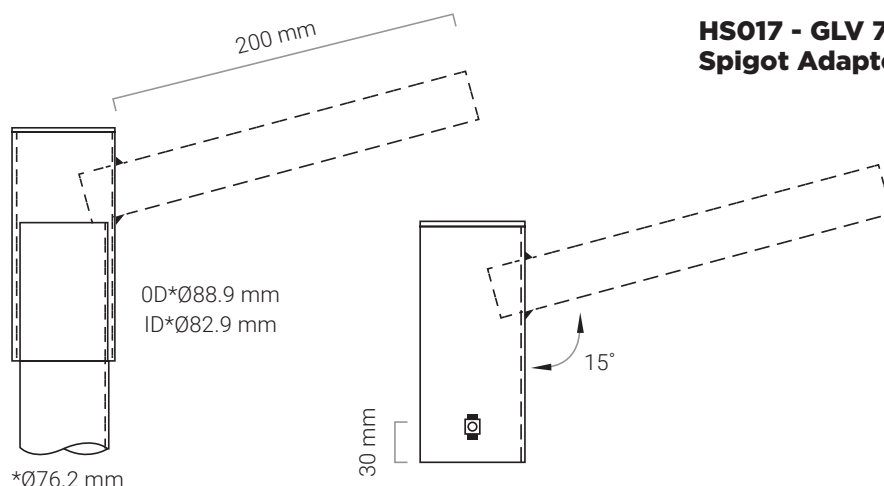
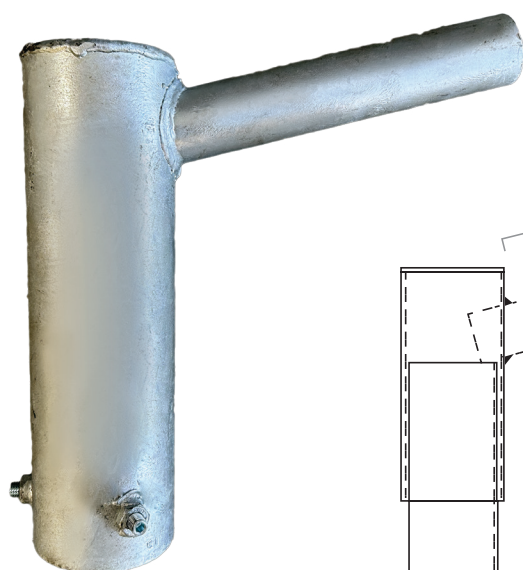

HS017 - GLV 76mm Spigot Adaptor